

# T SERIES

155 - 271 HP

**VALTRA**



**MACHINE  
OF THE YEAR 2015**

**YOUR  
WORKING  
MACHINE**

# YOUR WORKING MACHINE

Your land is your life.  
Your farm is your foundation.  
Your crop is your career.  
Your tractor is the tool of your trade.

That's why it's a Valtra.  
Like a craftsman's trusty tools, your Valtra gives you the confidence and the guts  
to get the job done. Every day. Every time. In every working environment.

At Valtra, we have always chosen the path less walked – because where we come from,  
that's how the paths are. We don't hesitate to walk the extra mile for you.  
We do things like this because it's the best way to do them.  
And because we believe in getting things done.

You don't compromise. Neither do we.

Get the job done.  
Get a Valtra.  
Your working machine.



## **YOUR**

It's all about you.....	4
Reliability, cost of ownership, ease of use....	6

## **WORKING**

Highlights.....	8
New cab/SkyView.....	10
SmartTouch armrest.....	14
Functional Scandinavian design.....	16

## **MACHINE**

Engine.....	20
Transmission.....	22
Options.....	24
Technology.....	26
Services.....	28
Technical data.....	32

# IT'S ALL ABOUT YOU

Where we come from, we don't talk much. But we listen to our customers. You told us that the three most important reasons for selecting a Valtra are reliability, low total operating costs, and ease of use. That's how we built the fourth generation of Valtra tractors.

We have been building tractors for more than 60 years, and the T Series is the culmination of our experience so far. We designed it for the diverse requirements of farmers and the most demanding of conditions. We are proud of the result.

Your working machine is built around you. Enter the cab, start the engine and see what the Valtra T Series can do on your farm.



# MAKE THREE WISHES AND GET IN THE DRIVER'S SEAT

If you could design and build a tractor, this is what it would look like. Many of the new T Series' unique features originated from our customers, because this tractor is the end result of discussions with hundreds of customers and thousands of hours of test driving.



## MODELS AND HORSEPOWER

**T144 HiTech** 155-170 HP  
**T144 Active** 155-170 HP  
**T144 Versu** 155-170 HP  
**T144 Direct** 155-170 HP

**T154 HiTech** 165-180 HP  
**T154 Active** 165-180 HP  
**T154 Versu** 165-180 HP  
**T154 Direct** 165-180 HP

**T174e HiTech** 175-190 HP  
**T174e Active** 175-190 HP  
**T174e Versu** 175-190 HP  
**T174e Direct** 175-190 HP

**T194 HiTech** 195-210 HP  
**T194 Active** 195-210 HP  
**T194 Versu** 195-210 HP  
**T194 Direct** 195-210 HP

**T214 HiTech** 215-230 HP  
**T214 Active** 215-230 HP  
**T214 Versu** 215-230 HP  
**T214 Direct** 215-230 HP

**T234 HiTech** 235-250 HP  
**T234 Active** 235-250 HP  
**T234 Versu** 235-250 HP  
**T234 Direct** 220-250 HP  
**T254 HiTech** 235-271 HP  
**T254 Active** 235-271 HP  
**T254 Versu** 235-271 HP

### Reliability

We stand behind the reliability of this tractor. The T Series has fewer parts than ever and went through 40,000 hours of test driving in extreme conditions. To ensure unrivalled reliability, we make all four of its major components in-house. The chassis, transmission and cab are Valtra's own design and engineering, and AGCO Power is the original Valtra engine that sets the reliability standard in our industry. The T Series is built for working in tough conditions - every day.

### Ease of use

We made owning, operating and servicing your tractor easy so that you can concentrate on your work. The controls in the cab are located to minimise body movement, transmission operation is easy with a new drive lever, and the bright work lights let you keep working when night falls. We paid extra attention to the daily maintenance points, so that checking the oil and cleaning the filters take as little time as possible. The T Series is well suited for your work because many of its unique features were actually innovated by our customers.

### Low total cost of ownership

The T Series isn't the cheapest tractor you can buy. But drive it for 10,000 hours and then you'll see the low total cost of ownership. For a start, we build your tractor for you, so you get only the features you need, factory installed and covered by the factory warranty. With AGCO Finance you tailor your financing costs. The 600 hour service interval reduces your maintenance costs and the SCR only AGCO Power engines give you the best overall fluid economy. Choose the T174 EcoPower model to save an additional 10% in fuel costs. Select PremiumCare and a service contract to secure your maintenance costs according to your annual running hours. And with genuine Valtra parts and 24/7 service you will get high resale value for your tractor. Valtra has one of the fastest parts delivery services in the industry to keep your working machine running, day in, day out.



It's made in Finland. We build more than 23,000 tractors a year and sell them in 75 countries, making us the market leader in Scandinavia and the fifth largest manufacturer in the western world. We have also been in Brazil since 1960, where we are the market leader in big tractors.

# HIGHLIGHTS OF YOUR NEW WORKING MACHINE

Every detail of this tractor has been developed to improve your productivity. The T Series has been perfected by our engineers and tested by our customers. Come in for a test drive!





## Comfort

1. The most comfortable 5-post cab
2. Intelligent cab frame with 365 Day visibility and over 6 m<sup>2</sup> window space
3. Pneumatic AIRES+ front axle suspension
4. Quiet working (<70 dB) in the 5-post cab
5. 270° sweep windscreen wiper and heated front\* and rear windows
6. Pneumatic AutoComfort cab suspension
7. Roof window
8. Electric TwinTrac reverse driving and 180° swiveling seat
9. Efficient LED lights
10. Safety camera

## Power

11. AGCO Power 6.6 l or 7.4 l engine, up to 250 hp and 1000 Nm
12. EcoPower fuel saving model
13. Fuel efficient Tier 4 Final / Stage 4 engine with SCR only
14. 600 hour service interval
15. 380 l fuel tank, 70 l AdBlue tank
16. Pillar air intake for engine
17. Rear mudguards
18. Pump variable displacement 200 l
19. Unique Valtra patented hydraulic assistant

## Your working machine

20. 5 speed Powershift with HiTech, Active and Versu, or Direct CVT
21. Electric 3-speed PTO with Sigma Power and ground speed PTO
22. Integrated 51 kN front lift and either a 81 kN or a 95 kN rear lift
23. Load-sensing hydraulics with 115, 160 or 200 l/min pump capacity
24. Factory installed front loader and cast subframe
25. Best ground clearance on the market (60 cm)
26. Max total weight 13,500 kg
27. Turning radius 5.25 m
28. 4th generation functional Scandinavian design
29. 4 piece front valves + 2 x 6/2
30. P/C right side window
31. Polycarbonate rear and side glasses

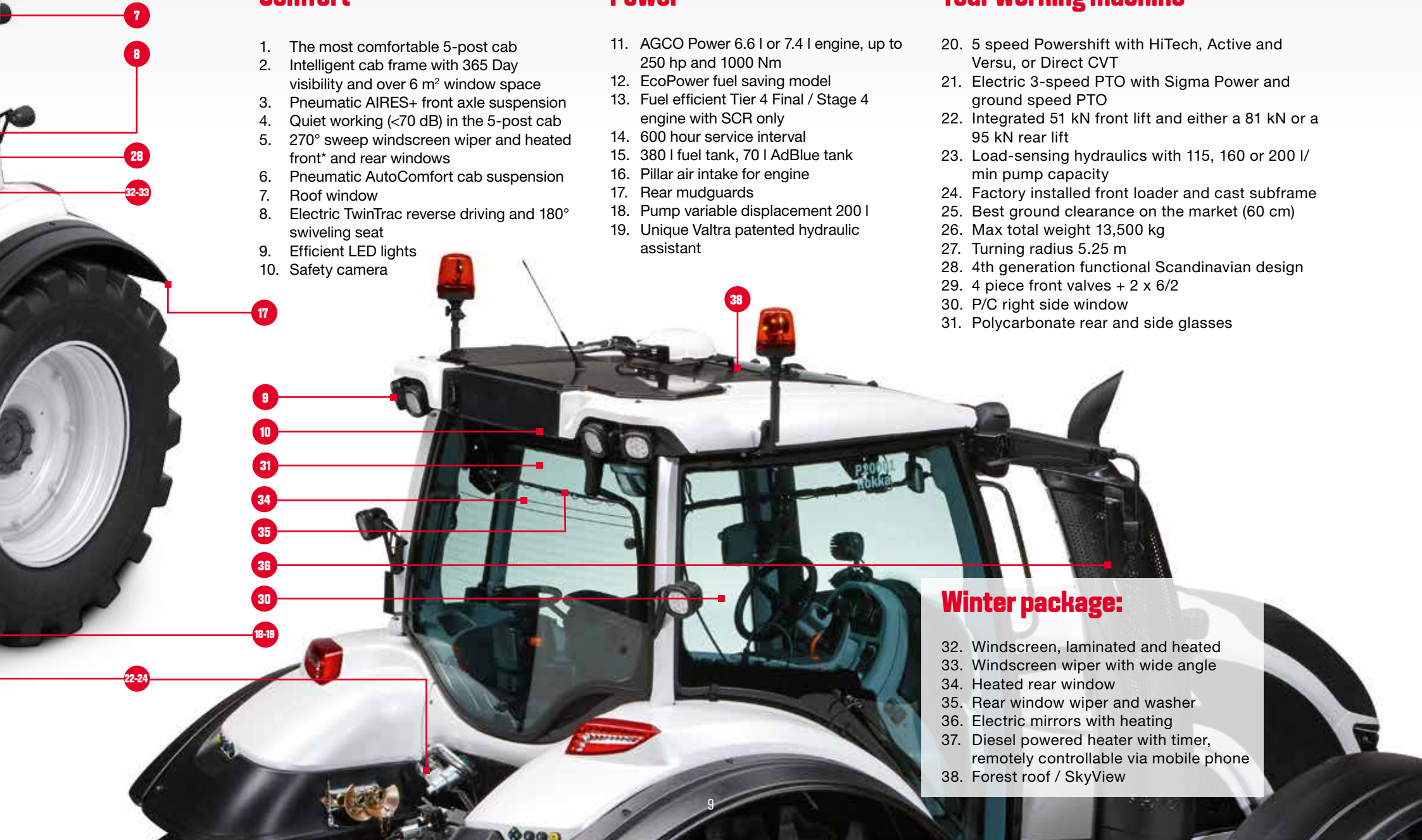

### Winter package:

32. Windscreen, laminated and heated
33. Windscreen wiper with wide angle
34. Heated rear window
35. Rear window wiper and washer
36. Electric mirrors with heating
37. Diesel powered heater with timer, remotely controllable via mobile phone
38. Forest roof / SkyView

# THIS CAB IS YOUR COMFORT ZONE

Make yourself comfortable.  
When it comes to productivity,  
the driver is central. That is  
why we never compromise  
on comfort, safety and  
ergonomics.



### **How is all this possible?**

The cab has a completely new frame and an innovative manufacturing process. It also has fewer parts and joints, making the cab structure very rigid and accurate in all 3D measurements. All this means that the cab fits like a glove. With its premium sound system, refrigerator and rear-view safety camera, the cab takes comfort to a whole new level. It even comes with an optional co-driver's seat. Just make three wishes and get into the driver's seat. The new cab is silent, secure, comfortable, and functional - your working machine.

T Series / 155 - 271 hp



# MORE SPACE, BETTER VISIBILITY, AND EVERYTHING UNDER CONTROL

You have more space where you need it, because the 5-post cab is convex. You have better visibility, with more than six square metres of window space. And you have more comfort and better control, both forward and in reverse using TwinTrac. The new SkyView cab offers window area of almost seven square meters.

## **365 Day Visibility Concept**

You get the best possible visibility day or night, summer or winter, undertaking front loader work or reverse driving. The narrow pillars and exhaust pipe design help you see your work. The 270° sweep front wiper keeps the heated front windscreen clear in all conditions and you can see the front loader bucket easily through the roof window. Premium LED working lights give you light in all directions. With black panel mode you can dim the interior to maximise your visibility outside and the optional safety camera gives you an unimpeded view of the hitch or working device. Efficient air conditioning and two heaters keep the temperature comfortable even when it's -30 degrees outside.

## **Comfort and control**

You notice the comfort as soon as you enter the cab – three steps and safe access through the wide-opening and soft-closing door. You have fingertip control of the new 5-speed powershift or Direct CVT, with a drive lever for driving and a joystick for controlling all tractor hydraulics. The cab has four seat options, from mechanical suspension to the Valtra Evolution seat with air conditioning and air suspension. Your co-driver also enjoys comfort and plenty of space. Two cab suspensions are available: luxury, semi-active pneumatic AutoComfort and a new mechanical suspension. The T Series has an all-new front axle with AIRES+ suspension that constantly monitors the ground and communicates with the AutoComfort cab suspension to make you feel as comfortable as possible. The basic

controls provide exactness, and an optional armrest control enables an enhanced touch to the front loader making more advanced tasks easier. Versu and Direct are standard fitted with SmartTouch user interface.

## **Functional Scandinavian design**

The cab has a unique shape to give you more space at shoulder and elbow height, but it is narrow at the front to keep the tractor as compact as possible. The convex windows optimise use of space, with over 6 m<sup>2</sup> of visibility in all directions. The Valtra cab is designed for reverse driving with TwinTrac. As always with Valtra tractors, the T Series cab offers a silent workplace (70 dB).

## **Technology on demand**

Most of the technology is available at the touch of a button. By pushing the ECO or U Pilot button, or engaging the transmission modes, the tractor handles itself automatically. With Auto-Guide you can drive with cm accuracy and with SmartTouch 9" terminal you control it easily as well as other technology options. AgCommand telemetry is available factory fitted and ready to use when the tractor arrives on your farm. Everything is integrated under the same service and warranty. We concentrate on the technology so you can focus on your work.

# COMMAND YOUR T SERIES

Valtra SmartTouch has raised usability to the new level. It's more intuitive than your SmartPhone. Settings are easily accessible within only two taps or swipes and all technology is integrated in to the new easy-to-use format: Guidance, ISOBUS, Telemetry, AgControl and TaskDoc.



Easy to navigate menu structure.



Logical to set up settings with swipe gestures. All settings are automatically stored in memory.



Intuitive way to set up settings with large controls and easy to understand functions.



From any control you can control any hydraulic service including hydraulic valves (front and rear), linkages (front and rear) or front loader



Easy configuration of worklights from the terminal. Worklights on/off switch in the armrest with beacon on/off switch.



Profiles for operators and implements which can be easily changed from any screen menu. All the setting changes will be saved in the selected profile



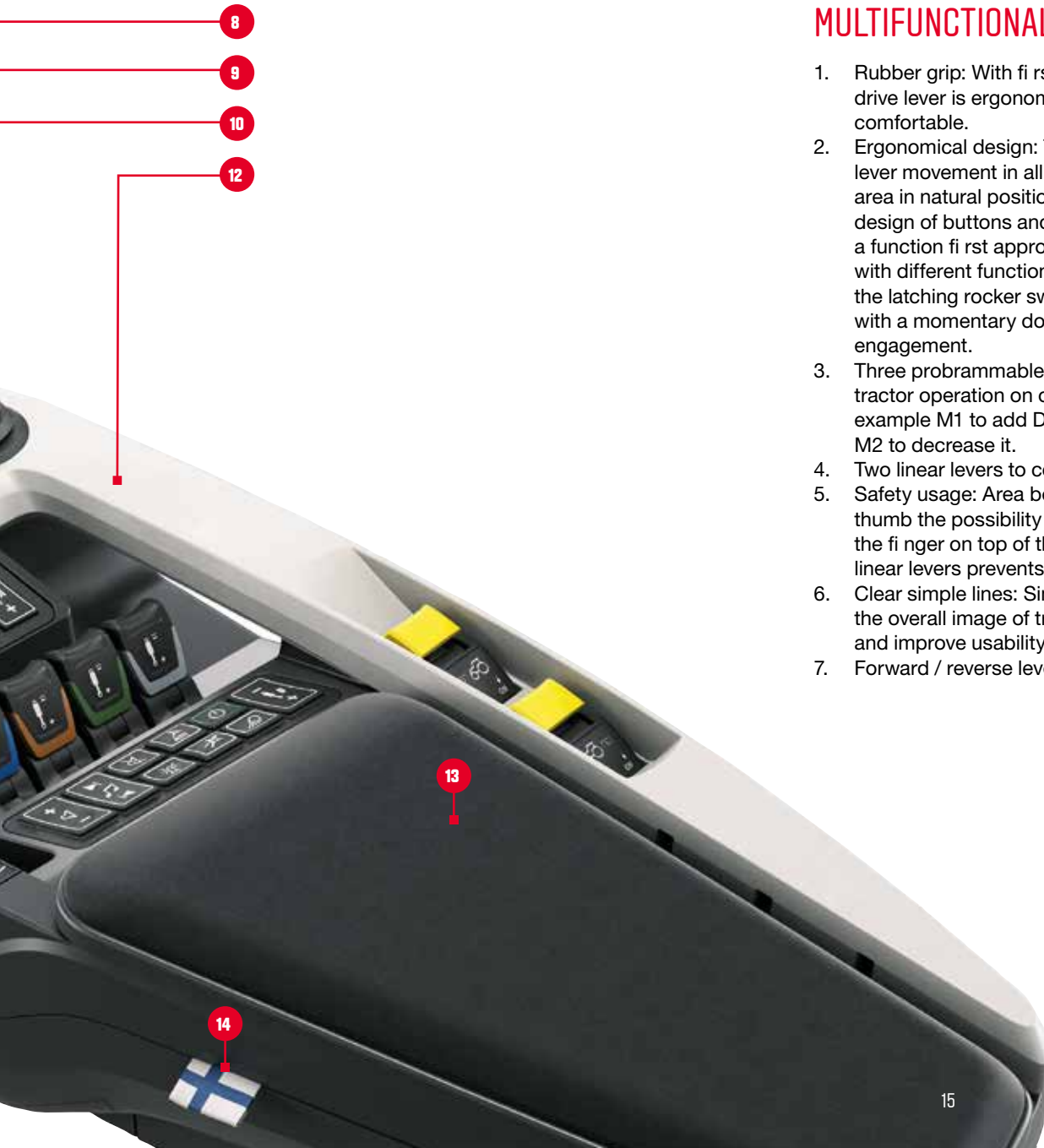

## MULTIFUNCTIONAL LEVER

1. Rubber grip: With first-class materials the drive lever is ergonomic, easy to use and comfortable.
2. Ergonomical design: The design allows for easy lever movement in all four directions. Button area in natural position for your thumb. The design of buttons and switches was done with a functional approach. Therefore buttons with different functions look different. Example: the latching rocker switch for the rear linkage with a momentary down function for fast soil engagement.
3. Three programmable memory buttons for any tractor operation (U-pilot). For example M1 to add Driving speed, cruise speed, M2 to decrease it.
4. Two linear levers to control hydraulics.
5. Safety usage: Area between buttons gives your thumb the possibility to rest without keeping the finger on top of the buttons. Humps around linear levers prevent error usage.
6. Clear simple lines: Simple and clear lines add to the overall image of tranquility and sturdiness, and improve usability.
7. Forward / reverse lever at the drive lever.

## SCREEN

8. No additional screens needed – Auto-Guide and safety camera displays are integrated to the SmartTouch screen. No need for additional monitors to block your visibility.

## JOYSTICK

9. Ergonomically positioned hydraulic joystick now includes 3rd control for hydraulics on top.

## BUTTON & REAR LINKAGE AREA

10. Buttons: Concave and convex shape helps find frequently used buttons easily and quickly.
11. Rear linkage - The easy-to-use limiter enables even the smallest adjustments of the rear linkage.

## DESIGN

12. Functional structure of the armrest provides good grip on rough terrain. All functions are easy to access due to logical layout and the armrest allows good support for the hand, reducing tensions and stress. Location of PTO switches minimizes unintentional usage.
13. Upholstery: Alcantara upholstery for less sweating. Storage space under the cover.
14. Designed in Finland.

IT'S NOT HOW MANY  
FEATURES WE PUT  
INTO IT THAT COUNTS.  
IT'S HOW MUCH YOU  
GET OUT OF IT.



Form follows function: this is the cornerstone of our design philosophy. The T Series highlights perfectly the way we think. It's functional, yet easy to operate and exciting to look at. Every detail is designed with a purpose in mind: to improve productivity and minimise the total cost of ownership.



#### **Intelligent frame**

With its long wheelbase, 2995 mm, the T Series gives good stability and a steady ride. This tractor also reaches a new level of agility, with a turning radius of just 5.25 m, thanks to the narrow engine construction, integrated front linkage and front PTO. At the same time, the frame structure enables us to design the bonnet in a way that improves visibility. While the T Series has a high ground clearance of 60 cm, the cab sits lower, making this the most compact 6-cylinder on the market.

#### **For heavy lifting**

The T Series is excellent for maximum grip thanks to its front/rear weight distribution of 40%/60%. The cast front loader sub-frame is fully integrated with the frame structure. The integrated front lift gives you the highest lifting capacity on the market, 51 kN in front and up to 95 kN in the rear. The unique 890 mm lift height makes it easy to work with implements.

Both a three-speed, electrically controlled PTO and a Ground Speed PTO are available for your Valtra T Series.

#### **Versatility concept**

Select the horsepower, the hydraulics, and the gearbox you need. Then select the options required for your work. We build tractors that give you unmatched flexibility. This is the ideal tractor for arable farming, with power on the ground and seamlessly working engine and transmission. For dairy and mixed farms we provide a wide range of options for mowing. This is the best solution for a contractor doing heavy front loader work, thanks to the patented hydraulic assistant. For forestry work, you can choose underside protection, the high-capacity hydraulic pump, a unique patented hydraulic assistant and SkyView cab with enhanced visibility. All options come factory installed and are covered by the factory warranty.



T Series / 155 - 271 hp

It's not just good looking, it's also good working.  
Every detail has been designed to make this tractor  
easy to drive and easy to own.

# WHERE WE COME FROM, WE MAKE OUR OWN ROADS



When we designed and developed the T Series tractor, there were no roads on the map. We had to make our own way. We designed and built the chassis and transmission in-house. And we have been working with AGCO Power engines as long as we have been making tractors – for more than 60 years.

**Starting reliably since 1951**

You have your choice of 6.6 or 7.4 litre engine, producing between 155 and 250 horsepower and up to 1000 Nm. AGCO Power has been the heart of Valtra tractors since we started manufacturing agricultural tractors in 1951. This gives Valtra tractors the reliability and long service interval that the competitors keep as their benchmark.



# THE BEST TRACTOR ENGINE, MADE IN FINLAND

We lowered the total cost of ownership by reducing fuel consumption and emissions to meet Tier 4 Final / Stage 4 engine regulations, while still delivering power where you need it. At the same time we have focused on keeping maintenance to the minimum, with SCR only emissions control.



### SCR only

We like to keep things as simple as possible. We have been on the market with SCR emissions control since 2008 and now we are really seeing the difference. SCR is a reliable and service free system, with no clogging components or wearing parts. DOC and SCR catalysers clean the exhaust gas without particle filters.

### Right sizing saves fuel

You get good responsiveness and fuel economy throughout the rpm range with the T Series' new turbo and 2000 bar injection pressure. You reach max torque at 1500 rpm. The T Series lowers fuel consumption with a new cooling package, a high pillar air intake, electronic viscous fan control, and optimised heat removal.

### Valtra EcoPower

With the Valtra T174 EcoPower model you can choose between two engine settings at the flick of a switch and minimise fuel consumption, especially for transport driving. The engine torque increases and the average piston speed is reduced by 20 percent. This not only reduces engine wear; it also means fuel savings of up to 10 percent. Idle speed is only 650 rpm.

### The Sigma Power boost

The Sigma Power feature gives up to 36 additional horsepower for PTO work when required. Sigma Power is especially useful when you are working with implements that demand a lot of PTO power, such as chippers, mowers, and power harrows.

### Market leading hydraulics

The Valtra Direct, Versu and Active models offer high-capacity load-sensing hydraulics with 115, 160 or 200 l/min hydraulic pumps. Valtra is the only tractor manufacturer that can offer the patented hydraulic assistant for powershift models. There are separate oils for the transmission and hydraulics, up to seven service valves in the rear and three valves in front. In Versu and Direct the valves are fully adjustable, with electronic control using the Valtra Arm. In Active the rear valves are mechanically controlled with the ergonomically located, clearly marked levers. The front valves, for the front loader, front lift or both, are electronically controlled with the joystick on the Valtra Arm in all models.



# UNBEATABLE RANGE OF CHOICE

Valtra T series offers more choices than anyone else – with the help of our experienced salesman your working machine can be tailored to match your exact needs. Valtra offers six power levels and four transmission and hydraulic combinations: Hitech, Active, Versu and Direct. Your Valtra T Series HiTech and Active models can be equipped with a standard user interface or with the practical and convenient Valtra ARM.

## HITECH

- 5PS, with open centre 73/90 litre hydraulics
- Mechanical hydraulic controls

In HiTech and Active the transmission control is robotized, so there are no mechanical gear levers. These tractors can be equipped with easy-to-use basic or with a control armrest that lets you operate all speeds with the small gear lever and the cruise control.

## ACTIVE

- 5PS, with load sensing hydraulics
- Mechanical hydraulic controls

Valtra Active is a revolutionary powershift technology with load sensing hydraulics at up to 200 l/minute, a hydraulic assistant and separate hydraulic and transmission oils.

## VERSU

- 5PS, with load sensing hydraulics
- Electrical hydraulic controls
- Valtra SmartTouch Arm with display
- Easy transmission and hydraulic settings

Valtra Versu is the king of the new generation powershift transmissions, with electronic hydraulic control, a hydraulic assistant, 115, 160 or 200 litre output, and separate hydraulic and transmission oils. It operates with the drive lever in automatic or manual mode. By choosing a Versu transmission, you get the ease of powershift and the flexibility of CVT in one package



### Join the Powershift Revolution

Valtra Powershift is the smoothest transmission on four wheels. Take your foot off the clutch and you are automatically in control – with Valtra you can drive your powershift tractor like a CVT. In automatic modes you shift automatically based on your acceleration and torque requirements – and you always get the best fuel economy.

The 5 step Powershift transmission has four ranges and is available in HiTech, Active and Versu. With two optional creeper

ranges, you have 30 speeds in both directions. The new gear lever, with manual and automatic modes, makes shifting precise and effortless. These models also have the Hill-hold feature, so you can get a smooth start with just the accelerator pedal, even uphill.

Valtra Versu models (as well as Active and Hitech for front loader) have a revolutionary, patented hydraulic assistant, giving you more hydraulic output automatically, either stationary or when driving, with no effect on driving speed. No other powershift can do it!



### DIRECT CVT

- CVT with load sensing hydraulics
- Electrical hydraulic controls
- Valtra SmartTouch Arm with display

This is the flagship of the range. The drive-lever control allows you to adjust the acceleration and deceleration with your right hand only. The versatile velocity setups have been further developed. We even offer a manual transmission control, which is needed for some special crops.



# UNIQUE VALTRA OPTIONS

Valtra is famous for the A la Carte ordering system. You can tailor your tractor together with your dealer using the electronic ordering tool. This is how we guarantee that you will get the working machine that matches your needs exactly. For the most demanding requirements, we also offer the Valtra Unlimited service, where you can find more options and make your tractor even more individual – Valtra is the only tractor manufacturer to offer this level of service.

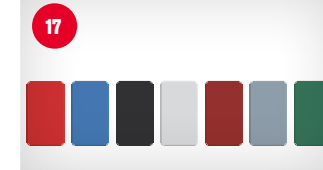





1. **TwinTrac** / Rear driving controls for reverse driving
2. **AutoComfort** / Luxury pneumatic cab suspension
3. **AIRES+** / Pneumatic front axle suspension
4. **Premium audio system** / Hifi stereo with subwoofer
5. **Premium working light options** / Excellent visibility for night work
6. **Sigma Power** / Gives an extra 15 hp for PTO work
7. **Roof window** / Best visibility for front loader work
8. **Refrigerator** / To keep your refreshments cool
9. **U-Pilot** / Headland management in Versu and Direct
10. **Valtra Evolution seat** / Luxury seat with air conditioning and air suspension
11. **Passenger seat** / Plenty of room in the cab for a co-driver
12. **Front loader** / The best visibility and hydraulics for loader use with patented hydraulic use.
13. **Tyre options** / A wide range for any type of work
14. **Toolbox** / Keep tools safe in a lockable service compartment
15. **Mechanical cab suspension** / For smooth driving
16. **Customer name** / Advertise yourself or your business
17. **7 standard colours**
18. **Front PTO**
19. **Front Lift** / 5-ton lift capacity for heavy duty applications
20. **High Speed** / Up to 53 or 57 km/h with reduced engine speed
21. **50 km/h** / Up to 53 km/h at reduced engine rpm
22. **Weights** / Front, rear, rim and ballast
23. **Valve packs (2-5)** / To meet all implement needs
24. **Power Beyond** / Max capacity up to 150 litres/min
25. **Hydraulic capacity** / of 115/160/200 litres /min
26. **Trailer hitch options** / Pick-up hitches and towing frames
27. **Electric power supplies** / available for all needs
28. **Front service valves** / Flexible use for front implements
29. **Winter package** / Heated rear window, Electric mirrors with heating, Windscreen, laminated and heated, Windscreen wiper with wide angle, Diesel powered heater with timer, remotely controllable via mobile phone
30. **Forest roof / SkyView**
31. **Cab with 2 doors**

# IT DOESN'T START WITH TECHNOLOGY. IT STARTS WITH YOU.

The new T Series makes it easy to utilise Valtra's latest technological solutions in order to further improve the productivity and profitability of your farming or contracting operations. Valtra is actively developing precision farming technologies as part of its FUSE strategy. One example of the user-based design of these technologies is that FUSE is an open system that can be used together with the machinery, products and applications of other manufacturers. This allows you to manage data from all the machinery and equipment on your farm so that the entire production chain is part of the same system. FUSE also makes the T Series compatible with future technologies.



# ONE SYSTEM FOR YOUR ENTIRE FARM AND ALL YOUR MACHINERY

## TECHNOLOGY

Auto-Guide: Automatic steering is the basics for precision farming. The control of Auto-Guide as well as other technology options is integrated into SmartTouch terminal. ISOBUS is the gateway to control any advanced implement. TaskDoc provides a quick, secure and reliable transfer of data between the machine in work and the planning in office. Section control (AgControl Section) turns automatically application equipment "sections" OFF as they cross previously covered areas and back ON in unapplied areas. Variable Rate Control (AgControl Variable Rate) enables the use of application maps and automated adjustment of the application rate on the implement, e.g. fertilize spreaders and seed drills.

## AUTO-GUIDE

Auto-Guide is Valtra's automatic steering system that is already used on thousands of tractors. The advanced system helps save time, fuel and material while reducing variations in performance among drivers.

T series HiTech and Active tractors are compatible with Auto-Guide 3000, and both can be fitted at the factory ready for use on delivery to the farm.

Telemetry system is a key part of Valtra's FUSE strategy. Key data about all the machinery on your farm, including engine data, location and operating hours, can be accessed almost in real time from your computer or smart phone. This makes it easier to plan the logistics of large farms and to monitor work performance. In addition, detailed service information can be sent to your local dealer, who can then anticipate servicing needs and reserve time to ensure the optimal performance of your machinery.

# AT YOUR SERVICE, AROUND THE WORLD AND NEAR YOUR FARM

It is extremely important for us at Valtra that your tractor remains reliable and in good working condition year after year. In addition, as part of the world's largest agricultural machinery manufacturer AGCO, we can offer services that help you manage the entire production chain and maximise the output and results of your work.



## **YOUR VALTRA DEALER**

Each Valtra dealer represents the best tractor and implement expertise in the world. They understand both the technical aspects of your tractor and the challenges you encounter in your everyday work. You can always turn to your dealer and receive the best service, whether you are interested in additional services or equipment, maintenance, spare parts, selling your tractor or ordering a new one. Each Valtra dealer is an independent entrepreneur just like you who works continuously to develop both his own operations and those of his customers. AGCO audits its dealers each year to ensure that you get the best possible service.

## **FLEXIBLE FINANCING SOLUTIONS**

AGCO Finance is a fast and safe option for financing the purchase of your next tractor. Financing is tailored individually based on your cash flow and operations. We offer

flexible payment methods according to your needs, and we take seasonal variations into consideration when planning payment schedules.

## **VALTRA PREMIUMCARE**

Valtra PremiumCare allows you to anticipate flexibly the maintenance costs of your investment so that you can better manage your running costs. Regular maintenance and a full service history help maximise the resale value of your tractor. Valtra PremiumCare also lets you minimise the lifecycle costs of your tractor. In addition, Valtra PremiumCare can include up to a five-year or 6000-hour extended factory warranty. The Valtra dealer service calculator will allow you to standardise your maintenance costs all the way up to 10,000 operating hours. Valtra PremiumCare is available with all Valtra models.

T Series / 155 - 271 hp

Ets GUERARD

VALTRA  
Service

Ets GUERARD  
11 Boulevard industriel  
76270 Neufchâtel-en-Bray  
Tél. 02 32 97 43 90

RENAULT

Traffic

BM-413-PG 76

### SPARE PARTS EVEN ON THE NEXT DAY

Valtra's comprehensive spare parts service supplies the parts you need as fast as by the next morning. This helps you keep your tractor productive in the midst of the busy ploughing and harvesting seasons. The AGCO Parts label ensures that you are getting original Valtra spare parts that have been thoroughly inspected and tested.

### PROFESSIONAL MAINTENANCE SERVICES

As a Valtra owner you have access to the Valtra service network. Our skilled technicians are experts in all Valtra tractor models, including the newest technologies and the latest features. Even if you do not opt for Valtra PremiumCare, having your tractor serviced regularly by Valtra-approved technicians ensures that your tractor will continue to perform well even during the busiest seasons. In addition, the resale value of your tractor will remain high.

### MY VALTRA

When you purchase a Valtra T Series tractor, you become part of a global online community that we call My Valtra. Here you can ask for advice, share working life, send photos and videos, and relate your experiences among other Valtra owners in over 50 countries around the world. [www.myvaltra.com](http://www.myvaltra.com)

### VALTRA TEAM

Valtra Team is our customer magazine which is published twice a year. Each issue contains useful information about the latest innovations, including the newest and most efficient work methods. You can also access the magazine's archives on the internet and read the articles that interest you most dating back to 2000.





#### **AGCO ACADEMY**

Tractors and related technologies, especially precision farming technologies, are developing at a rapid pace. The Valtra Academy continuously trains Valtra dealers and service technicians. In this way you can be sure that you always receive first-class and up-to-date expertise from your Valtra dealer and service technicians.

#### **VALTRA COLLECTION**

The Valtra Collection offers high-quality clothing and accessories for work and leisure. The materials and details are carefully selected according to the type of clothing. For example, the newest collection of work clothes features light yet extremely durable materials. Style has not been overlooked, as the clothing reflects Valtra's modern design language.



#### **AGCO - LEADING THE WAY - FEARLESSLY**

We are one of the world's most influential producers of farm machinery – a leader in product development, a leader in technology and a leader in customer service.

AGCO is the world's largest manufacturer focused purely on agriculture. Our high-tech solutions and vast experience of global agriculture mean AGCO is uniquely placed to increase your farm's productivity.

AGCO meets individual farming needs. From the most demanding challenges to everyday tasks, our multiple brands and customer-focused services enable us to give you exactly what you need, when you need it.

AGCO's global presence ensures that professional farmers worldwide have the tools they need to maximise their crop yield and meet growing demands.

# TECHNICAL SPECIFICATIONS





TRACTOR MODEL	T144	T154	T174e	T194	T214	T234	T254
<b>ENGINE</b>			std mode	eco mode			
Engine, Agco Power	66 AWF		74 EWF	74 EWF	74 EWF	74 EWF	74 EWF
No of cylinders /Capacity [l]	6/6.6		6/7.4	6/7.4	6/7.4	6/7.4	
Emission control	Tier 4 Final / Stage 4 - "SCR only" system with DOC and SCR Catalysts						
Standard Max Power, [kW]	114	121	129	143,5	158	162	173
Standard Max Power, [hp]	155	165	175	195	215	220*	235
Boost Max Power, [kW]	125	132	140	154,5	169	184	184
Boost Max Power, [hp]	170	180	190	210	230	250	271
at engine speed [r/min]	1900		1900	1700	1900		
Nominal engine speed [r/min]	2100		2100	1800	2100		
Standard Max Torque, [Nm]	640	680	740	850	800	870	930
Boost Max Torque, [Nm]	680	740	780	900	870	910	1000
at engine revs	1500		1500	1100	1500		
<b>TRANSMISSION</b>							
HiTech	X	X	X	X	X	X	x
Active	X	X	X	X	X	X	x
Versu	X	X	X	X	X	X	x
Direct	X	X	X	X	X	x	
<b>DIMENSIONS</b>							
Wheel base [mm]	2995						
Length [mm]	5800						
Height [mm]	3130						
Turning radius (600/65R28, track 1960mm) [m]	5.25						
Fuel capacity [l]	380						
AdBlue capacity [l]	70						
Ground clearance MID [mm]	600						
Weight (full tanks) [kg]*	7300						
Weight distribution F/R [%]	40/60						
Max front axle weight [kg]	5500						
Max rear axle weight [kg]	9000						
Gross vehicle weight [kg]	13500						

\*T234 Hitech, Active and Versu: STD max. Power 235 HP/ 173 kW and max. torque STD/Boost: 930/1000 Nm.

TRANSMISSION	HITECH	ACTIVE	VERSU	DIRECT
<b>ENGINE</b>				
5 step Powershift; 4 work areas + creeper	X	X	X	--
CVT	--			X
Speed range	0.6-43			0-43
Alternative speed range	0.7 - 53 or 0.7 - 57*			0-53 or 0-57*
Group gear (work areas)	A,B,C,D			
Ranges	automated			
Number of speeds with creeper	30			CVT
Creeper	STD			CVT
Number of creeper gears	10			CVT
Brakes rear	multi-disc/plates oil cooled wet brakes with hydraulic boost			
Brakes front axle	option			
Type of main clutch	wet multi-disc			
Front axle suspension type (option)	AIRES+ pneumatic			
<b>HYDRAULICS</b>				
Hydraulic system	Open Center	load sensing		
Pump capacity (option)	73 (90)	115 (160/200)		
Oil available for implements [l]	40	47		
Mechanical valves rear	up to 4		--	
Power Beyond	--	up to 150 l/min		
Electronic valves rear	--		up to 5	
ON/OFF valve rear	--	1	up to 2	
Electronic valves front [option]	2, 3 or 4			
<b>POWER LIFT</b>				
Lift capacity rear, max [kN]	78	78 (95)		
Lifting range [mm]	868			
Optional front lift capacity, max [kN]	51			
<b>POWER TAKE OFF</b>				
540 / 1000	STD			
540/540E/1000	Option			
540E/1000/1000E	Option			
Ground speed PTO	Option			
Front PTO 1000	Option			

\*High speed models available on models T174-T254. There can be limitations concerning equipment and tyres.

CAB	HITECH	ACTIVE	VERSU	DIRECT
Operator's seat swivel angle	180°			
Co-drivers seat with safety belt	Option			
Noise level [dB]	<70			
No of doors	1/2			
No of windows STD	5/6			
Roof window	Option			
Window area with roof window [m <sup>2</sup> ]	6.22			
Window area with forest roof (Skyview) [m <sup>2</sup> ]	7.00			
P/C right side window	Option			
Polycarbonate rear and side glasses	Option			
Windscreen wiper work angle	STD 180°, Optional 270°			
Valtra ARM control armrest w/o terminal	Option	Option	--	--
Valtra SmartTouch	--	--	STD	STD
Transmission control without Valtra Arm	Option	Option	--	--
Air conditioning and heater in the roof	Option			
2nd heating for footwell	Option			
Automatic climate control with 2 heaters	Option (not available for Skyview)			
Refrigerator	Option			
Mechanical cab suspension	Option			
AutoComfort semi-active air suspension	Option			
TwinTrack reverse drive	Option			
QuickSteer	Option			
Auto-Guide	Option (not available for Skyview)			
2 Safety cameras	Option			
Windscreen, laminated and heated	Option			

**THE ALL-NEW T SERIES,  
REDESIGNED FROM THE  
GRILLE TO THE TAILLIGHTS.**

**VALTRA**



Valtra is a worldwide brand of AGCO.

Valtra Inc.  
Valmetinkatu 2  
FI-44200 Suolahti

Tel. +358 (0)2045 501  
Fax +358 (0)2045 50608

The tractors that appear in this brochure may be equipped with special options. Changes possible - all rights reserved.

**YOUR  
WORKING  
MACHINE**