

SAKAI®

SV540

Series

Soil Compactor



SV540T

Vibratory Single Drum Roller

The innovatively designed SV540 is applicable to medium to large soil compaction jobs. The SV540 includes new roller features and optimizes job profitability through efficiency.

Proven Compaction Performance

- Roller compactive force reaches target density in fewer roller passes.
- Provides higher centrifugal force and amplitude.
- Achieves uniform compaction throughout lift thickness.

Standard Automatic Traction Control

- Anti-slip control system for drum and tires ensures compaction while traveling forward or in reverse—even on jobs with soft ground, slopes or rough terrains.

Low Operating Costs

- Sakai's new ECO Compaction Mode (ECM) reduces fuel consumption up to 20% while maintaining powerful performance.
- Durable, quality components such as the hydraulics, drum, and center-pin hitch assure longer life and lower maintenance costs.
- Sakai's unique drum mounting system extends the life of the drum isolators

Operator Comfort and Safety

- Includes Sakai's durable dual rubber isolation system between the drum and the operator deck.
- Brake pedal comes standard for added safety.
- Large, comfortable cab with many standard features and your choice of options



SV540D

www.sakaiamerica.com

Options shown. Contact your dealer for details.

SV540 Series

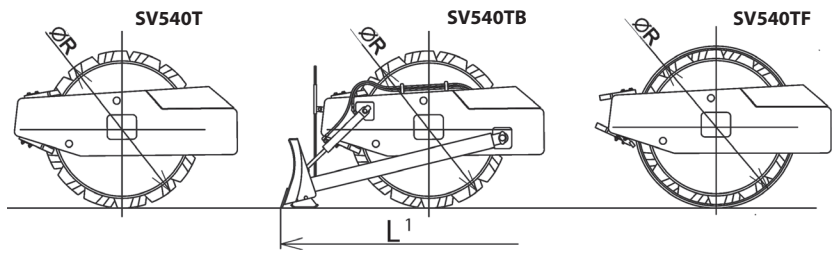
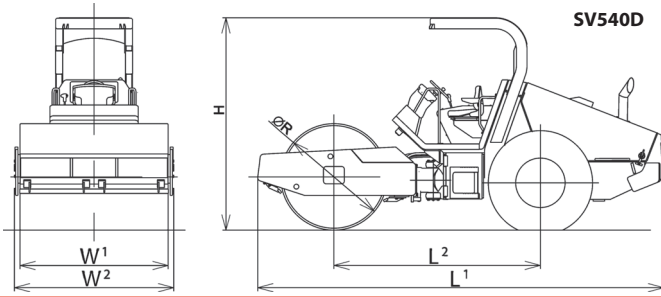

TYPE		MODEL	
CHASSIS MODEL			
WEIGHTS	Operating weight [with ROPS]	kg(lbs)	
	Load on front axle [operating weight with ROPS]	kg(lbs)	
	Load on rear axle [operating weight with ROPS]	kg(lbs)	
PERFORMANCE	Centrifugal force [L / H]	kN(lbs)(kgf)	
	Frequency [L / H]	Hz(vpm)	
	Amplitude [L / H]	mm(in)	
	Dynamic linear pressure for front drum [operating weight with ROPS][L / H]	N/cm (lb/in)	
	No.of speeds		
	Speed range [L / H]	km/h(mph)	
	Gradability	%(°)	
	Min.turning radius [outer]	m(in)	
	DIMENSIONS	Overall length L ¹	mm(in)
		Overall width W ²	mm(in)
		Overall height [without ROPS]	mm(in)
		Overall height [with ROPS] H	mm(in)
		Wheelbase L ²	mm(in)
		Width with leveling blade	mm(in)
		Compaction width W ¹	mm(in)
		Drum width W ¹ / Drum diameter R	mm(in)
		Pad height	mm(in)
No.of pads		pcs.	
Shell thickness	mm(in)		
Tire size × No.of tires			
Inflation [each wheel]	kPa(psi)		
Ground clearance	mm(in)		
Curb clearance	mm(in)		
Side clearance	mm(in)		
ENGINE	Make		
	Model		
	EPA emission standard		
	Type		
	Displacement	L(cu.in)	
	Rated output	kW(HP)/min-1	
	Electric system battery	V(V/CCA×Qty)	
POWER LINE	Electric system alternator	V/A	
	Transmission		
	Type		
VIBRATION SYSTEM	Drive		
	No.of amplitude		
BRAKE SYSTEM	Vibrator		
	Service (working)		
	Secondary (emergency)		
STEERING SYSTEM	Parking (parking)		
	Type		
FLUID CAPACITY	Articulation / Oscillation	±(°)	
	Fuel tank	L(gal)	
	Hydraulic tank	L(gal)	

Vibratory Single Drum Roller					
SV540D	SV540T	SV540TB	SV540FB	SV540TF	SV540DF
3SV53					
10,710(23,610)	11,090(24,450)	11,770(25,950)	14,035(30,940)	13,350(29,430)	12,385(27,305)
5,470(12,060)	5,855(12,910)	6,760(14,905)	9,040(19,930)	8,120(17,900)	7,215(15,905)
5,240(11,550)	5,235(11,540)	5,010(11,045)	4,995(11,010)	5,230(11,530)	5,170(11,400)
172 / 255					
(38,665 / 57,325)					
[17,440 / 26,000]					
33.3 / 28.3(2,000 / 1,700)					
1.02 / 2.09	0.95 / 1.94		0.62 / 1.27		0.73 / 1.50
(0.040 / 0.082)	(0.037 / 0.076)		(0.024 / 0.050)		(0.029 / 0.059)
1,059 / 1,449	-	-	1,181 / 1,571		-
(605 / 827)			(675 / 897)		
2					
0 - 6 / 0 - 10(0 - 3.7 / 0 - 6.2)					
62(32)		58(30)	43(23)	46(25)	48(26)
5.6(221)					
5,840(230)	5,835(230)	6,250(250)	6,245(246)		5,840(230)
2,295(90)					
2,190(86)		2,265(89)		2,255(89)	2,240(88)
3,050(120)		3,110(122)		3,115(123)	3,130(123)
2,970(117)					
-	-	2,800(110)		-	-
2,130(84)					
2,130 / 1,530		2,130 / 1,600			2,130 / 1,708
(84 / 60)		(84 / 63)			(84 / 67)
-		100(4)			75(3)
-		140			160
25(0.98)		22(0.87)			25(0.98)
23.1-26-8PR(OR)×2		23.1-26-10PR(OR)×2			
137.34(19.9)					
405(15.5)	450(17.5)		465(18)		475(18.5)
500(19.5)	530(20.5)		560(22)		580(22.5)
82.5(3)		335(13.5)		82.5(3)	
CUMMINS					
QSB 4.5					
EPA Interim Tier 4					
Diesel, water cooled, 4 cycle, 4 cylinder with turbo charger					
4.460(272.2)					
119(160) / 2,200					
24(12 / 760×2)					
24 / 70					
Hydrostatic transmission					
Hydraulic					
All wheel					
Hydrostatic					
2					
Eccentric shaft type					
Hydrostatic dynamic brake through drive system / FNR Lever					
Hydrostatic + Spring-applied hydraulically released (SAHR) / Brake pedal					
SAHR / Panel button					
Hydraulic(Articulated)					
37 / 9.0					
265(70)					
50(13)					

- Operating weight : 100% Fuel, 100% Water, no Operator.
- Specifications are subject to change without notice.
- Above specified numbers could be deviated within ±5%.
- All units are SI units. Inside of () is for reference units.
- The photos may contain optional equipment and/or attachments.

Optional Equipment

- ROPS+CAB • Mirrors • Air conditioner • Work lights
- Rotary beacon • Compaction Control unit ; CCV,CIS • Telematics



SAKAI AMERICA, INC.
(800) 323-0535

90 INTERNATIONAL PARKWAY, ADAIRSVILLE, GEORGIA 30103