

# Specification sheet

## FA CF85



072F8509ABAA - 201949c - 29-08-2019

ENGINES
CF85 360
CF85 360
CF85 410
CF85 410
CF85 460

GVM <sup>1)</sup>	GCM <sup>2)</sup>
17500 kg	44000 kg
Max. front 7500 kg	
Max. rear 10000 kg	

Belarus, TurbotrucksBel JLLC, [www.turbotrucks.by](http://www.turbotrucks.by)

## CAB EXTERIOR

Mechanically suspended Day Cab with steel bumper, tinted glass and electric window openers. Main mirrors and wide angle mirrors electrically heated. Cab width 2300 mm.; Manually adjustable main mirrors; Front view mirror.

### Optional

<b>02106</b> Sleeper Cab	<b>06166</b> Combi lights in bumper
<b>01137</b> Space Cab	<b>07313</b> Combi lights led in bumper
<b>01226</b> Cab suspension air	<b>06592</b> Four spot lights on the cab roof
<b>08071</b> Xenon head lights with washer	<b>06593</b> Skylights
<b>00396</b> Permanent driving lights	<b>06591</b> Two spot lights on the cab roof

## AERODYNAMICS

### Optional

<b>04906</b> Side collars
---------------------------

## COLOURS

Cab colour H3279 Brilliant White; Head lamp panel, bumper and step cover: grey; Chassis colour grey..

### Optional

<b>09932</b> Head lamp panel, bumper and step cover: Br White	<b>04198</b> Mirror covers in cab colour
<b>09931</b> Head lamp panel, bumper and step cover: cab colour	<b>16153</b> Cab and chassis colours

## CAB INTERIOR

Driver seat: Comfort Air; Co-driver seat: basic; Storage box on engine tunnel; No air conditioning; Roof hatch glass, manual control.

### Optional

<b>09271</b> Steering wheel, leather, colour black	<b>06539</b> Refrigerator
<b>06111</b> Dashboard: wood structure	<b>06599</b> Auxiliary cab heater (air)
<b>02117</b> Third seat	<b>06516</b> Auxiliary cab heater (water)

## COMMUNICATION AND DRIVING MANAGEMENT

No Fleet Management System; Tachograph mechanical; Speed limiter setting 85 km/h nominal; Antennas: AM/FM, 2x GSM, GPS; Cruise control.

### Optional

<b>09681</b> Preparation for Maut	<b>09721</b> Handsfree telephone kit
<b>16155</b> Audio equipment, makes and types	<b>09909</b> Adaptive Cruise Control (ACC) with FCW

## SAFETY AND SECURITY

Basic engine immobiliser system.

### Optional

<b>08631</b> Air bag (driver) and 2 seat belt tensioners	<b>01723</b> No reverse warning
<b>09992</b> Lane Departure Warning System	

## SUSPENSION AND AXLES

Front: 7.50 t, parabolic, 152N; Rear: 13.00 t, air suspension, SR1347.

### Optional

<b>06257</b> Front axle load 9.00 t	<b>01603</b> Rear springs parabolic
<b>04057</b> Rear axle HR1356	

## WHEELS AND TYRES

Front axle 1: 315/80R22.5; Rear axle 1: 315/80R22.5; Spare: 315/80R22.5; Disc wheels steel, silvergrey; Wheel protection rings silvergrey.

### Optional

<b>16152</b> Tyre makes and types
-----------------------------------

## DRIVELINE

MX265, 265 kW/360 hp, 45C HD. Cab badge: 360; Exhaust emission Euro 3; No engine idle shutdown; Manual gearbox, 16 speeds; Gearbox ratio 13.80-0.84; Rear axle ratio 3.31; Mechanical differential lock.

### Optional

<b>04001</b> Exhaust emission Euro 5	<b>02313</b> Gearbox direct drive
<b>04500</b> AS Tronic gearbox, 12 speeds	<b>03721</b> ASR

## BRAKE SYSTEM

Exhaust brake; ABS.

### Optional

<b>09921</b> MX Engine Brake	<b>02715</b> ZF Intarder
------------------------------	--------------------------

## CHASSIS

Wheelbase 4.50 m / rear overhang 1.95 m; Side member height 310 mm; Steel fuel tank 300 l, height 580 mm; Spray suppression; Front underrun protection (FUP); No AdBlue tank; Spare wheel carrier side.

### Optional

<b>16157</b> Fuel tanks, material and sizes	<b>13487</b> AdBlue tank 60 litres
---	------------------------------------

## DRAWBAR AND TRAILER EQUIPMENT

D-value cross member D=13.7; Pneumatic trailer connection palm type; Electric connection 24 V / 2x7 pins.

### Optional

<b>04624</b> Closing member	<b>07032</b> D-value cross member D=20
-----------------------------	--

## BODIES AND PREPARATIONS FOR BODYING

Application connector on the cab front.

### Optional

<b>04331</b> Appl connector including air control prep	<b>02597</b> Application connector for tail lift control
<b>06692</b> Application connector on the chassis	

## POWER TAKE-OFF (PTO)

### Optional

<b>16148</b> PTO types and positions
--------------------------------------

## ELECTRICAL POWER SUPPLY

Alternator 80 A, batteries 2x 175 Ah..

### Optional

<b>04873</b> Alternator 110 A	<b>06440</b> Batteries 2x230Ah
-------------------------------	--------------------------------

## GVM AND GCM

Chassis weight related technical GVM max 20500 kg; Driveline related max GCM 44000 kg class 2.

### Optional

**00939** Driveline related max  
GCM 56000 kg class 2

## APPLICATION CONDITIONS

Moisture separator, heated; Cyclonic air intake behind the cab.

### Optional

**02270** Cold climate

## SERVICE AND MAINTENANCE

Standard Warranty takes care of 1 year complete vehicle, 2nd year driveline and 1st year breakdown.; ITS service.



**Go to [DAF.com](https://www.daf.com) to configure your own perfect DAF.**

# FA CF85

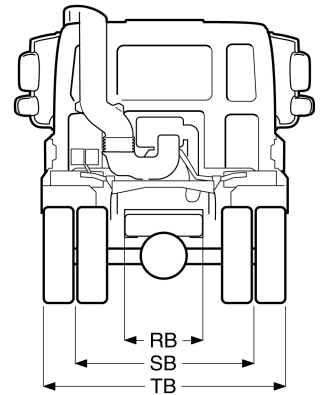
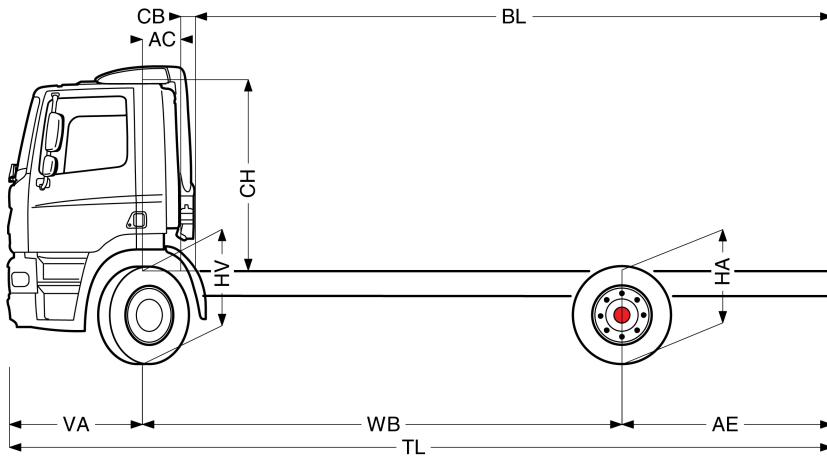

	Wheelbase - AE		Unladen weight <sup>9)</sup>			Gross Carrying Capacity			Variable dimensions									
	WB	AE <sup>8)</sup>	Front	Rear	Total	Front	Rear	Total	AC	CB <sup>6)</sup>	CH <sup>7)</sup>	BL <sup>8)</sup>	BL	TL	HA <sup>9)</sup>	HA <sup>10)</sup>	TK <sup>11)</sup>	TW <sup>12)</sup>
SPACE CAB	4.00	1.70	4826	2225	7051	2674	7775	10449	0.82	0.18	2.58	3.96	3.96	7.08	1.12	1.01	13.94	15.32
	4.20	1.80	4824	2252	7076	2676	7748	10424	0.82	0.18	2.58	4.25	4.25	7.38	1.12	1.01	14.46	15.85
	4.50	1.95	4847	2291	7138	2653	7709	10362	0.82	0.18	2.58	4.70	4.70	7.83	1.05	1.03	15.24	16.64
	4.70	2.05	4842	2307	7150	2658	7693	10350	0.82	0.18	2.58	5.00	5.00	8.13	1.05	1.03	15.76	17.17
	4.90	2.15	4844	2332	7175	2656	7668	10325	0.82	0.18	2.58	5.29	5.29	8.43	1.05	1.03	16.28	17.70
	5.10	2.30	4838	2355	7193	2662	7645	10307	0.82	0.18	2.58	5.58	5.58	8.78	1.05	1.03	16.81	18.23
	5.40	2.40	4897	2461	7357	2603	7539	10143	0.82	0.18	2.58	6.04	6.04	9.18	1.05	1.03	17.59	19.02
5.70	2.65	4897	2511	7408	2603	7489	10092	0.82	0.18	2.58	6.47	6.47	9.73	1.05	1.03	18.37	19.81	
DAY CAB	4.00	1.70	4658	2226	6884	2842	7774	10616	0.39	0.20	1.91	4.68	4.68	7.08	1.12	1.02	13.94	15.32
	4.20	1.80	4656	2252	6908	2844	7748	10592	0.39	0.20	1.91	4.97	4.97	7.38	1.12	1.02	14.46	15.85
	4.50	1.95	4681	2290	6971	2819	7710	10529	0.39	0.20	1.91	5.42	5.42	7.83	1.05	1.03	15.24	16.64
	4.70	2.05	4676	2306	6982	2824	7694	10518	0.39	0.20	1.91	5.71	5.71	8.13	1.05	1.03	15.76	17.17
	4.90	2.15	4677	2331	7008	2823	7669	10492	0.39	0.20	1.91	5.99	5.99	8.43	1.05	1.03	16.28	17.70
	5.10	2.30	4672	2354	7026	2828	7646	10474	0.39	0.20	1.91	6.28	6.28	8.78	1.05	1.03	16.81	18.23
	5.40	2.40	4730	2460	7190	2770	7540	10310	0.39	0.20	1.91	6.73	6.73	9.18	1.05	1.03	17.59	19.02
5.70	2.65	4730	2510	7240	2770	7490	10260	0.39	0.20	1.91	7.15	7.15	9.73	1.05	1.03	18.37	19.81	
SLEEPER CAB	4.00	1.70	4726	2227	6953	2774	7773	10547	0.82	0.18	1.91	3.90	3.90	7.08	1.12	1.01	13.94	15.32
	4.20	1.80	4725	2253	6978	2775	7747	10522	0.82	0.18	1.91	4.19	4.19	7.38	1.12	1.01	14.46	15.85
	4.50	1.95	4749	2291	7040	2751	7709	10460	0.82	0.18	1.91	4.64	4.64	7.83	1.05	1.03	15.24	16.64
	4.70	2.05	4744	2308	7052	2756	7692	10448	0.82	0.18	1.91	4.93	4.93	8.13	1.05	1.03	15.76	17.17
	4.90	2.15	4745	2332	7077	2755	7668	10423	0.82	0.18	1.91	5.22	5.22	8.43	1.05	1.03	16.28	17.70
	5.10	2.30	4740	2355	7095	2760	7645	10405	0.82	0.18	1.91	5.50	5.50	8.78	1.05	1.03	16.81	18.23
	5.40	2.40	4798	2461	7259	2702	7539	10241	0.82	0.18	1.91	5.96	5.96	9.18	1.05	1.03	17.59	19.02
5.70	2.65	4798	2511	7310	2702	7489	10190	0.82	0.18	1.91	6.39	6.39	9.73	1.05	1.03	18.37	19.81	

OTHER DIMENSIONS      VA: 1.38    HV<sup>13)</sup>: 1.04    HV<sup>14)</sup>: 0.99    RB: 0.79    SB: 1.82    TB: 2.48

- GVM in conformity with registration documents.
- GCM in conformity with registration documents.
- Axle load with standard tyre size.
- Chassis and cab weight calculated with: Standard specification items only with 300 litres of fuel, 0 litres of AdBlue and driver of 80 kg, tolerance  $\pm 3\%$ . Changing of the specification can have major impact on vehicle weight.
- Other AE dimensions may be available for shown WB. Modify rear overhang to the calculated body length.
- CB is based on standard air intake and/or exhaust.
- Cab height is measured from frame member to closed cabin roof hatch. With air intake on cab roof: +0.14 m.

- Calculate customer specific body length with TOPEC. Body lengths shown based on evenly distributed load at max axle load.
- Unladen height at centre of driven axle(s).
- Laden height at centre of driven axle(s).
- TK = turning circle between kerbs.
- TW = turning circle between walls.
- Unladen height at centre of front axle(s).
- Laden height at centre of front axle(s).

Depending on the vehicle configuration a specific option may not be possible. The availability and specification of this vehicle may differ per country. For further information please contact the DAF organisation. Pictures and technical illustrations are not binding in detail and can differ from the standard specification. Subject to modification without prior notice.