

Multiprocessor CU230

Concrete and scrap shear for mini excavators

www.arden-equipment.com

- 1 Bolt on top plate.
- 2 Continuous 360° hydraulic rotation, motor + slewing ring.
- 3 2 reversed vertical cylinders.
- 4 Body in high tensile steel. HF treated pins.
- 5 Jaws made of 450HB steel + hard welding.
- 6 Rebar cutter with reversible blades.

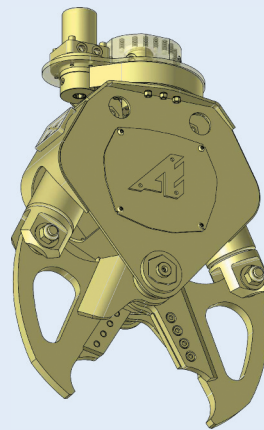
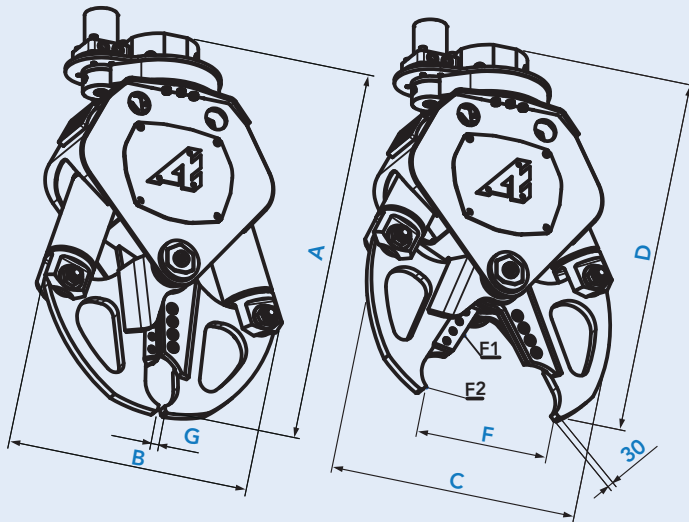

BF jaws

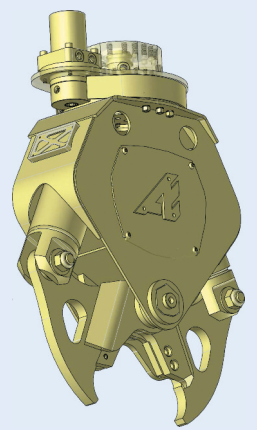

CB jaws

CE	kg	A	B	C	D	F	G	F1	F2	UPN	●	IPE	360°	Hydraulic		t	
		mm	mm	mm	mm	mm	mm	t	t	mm	mm	mm		bar	l/s		bar
CU0230 BF*	240	1 116	739	746	1 054	404	19	55	25	100	30	120	100	15	250	50/70	2/4,5
CU0230 CB*	235	1 016	739	743	968	303	14	68	34	-	30	-					

Weight (±3%) without top plate.

* BF = Combi jaws - CB = Concrete crusher.

9, avenue de l'Industrie - F-08000 CHARLEVILLE-MÉZIÈRES - Tel. : (33) 03 24 33 64 30 - Fax : (33) 03 24 33 64 32