



Machines

High performance plate compactors 420-730 kilos
AVH 5030 / AVH 6030 / AVH 100-200



Universal application in soil compaction



3m
Ammann 3-Wellen-
Hochleistungsverdichter
Excitateur à 3 arbres haute performance
High Performance Triple Shaft Exciter System





The unique triple-shaft exciter

Triple-shaft exciter system

The facts:

The new triple-shaft exciter system has been designed to improve the maneuverability and climb ability of a vibration plate in a revolutionary way. When working in cohesive material the unfavorable tilting action of plates, fitted with conventional double shaft exciter systems, and the lack of powerful climbing ability prevented the use of such machines or provided poor compaction results. The ease in handling and maneuvering of the machine can be felt particularly when the use of low frequency – high amplitude is requested. The triple shaft exciter system causes the plate to avoid erratic movements, allowing a smooth travel even through heavy, cohesive soil. The unique and even running travel rhythm makes the plate effortlessly climb over obstacles and/or backfill with high moisture content without the usual suction effect, which often causes the plate to come to a complete standstill. The AVH 5030, AVH 6030 and AVH 100-20 are fully hydraulic vibrating plates and have been designed with the most favorable balance between impact force and centrifugal force in their respective weight classes.

The result:

Maximum compaction performance – 60 kN or 100 kN respectively. Based on the triple shaft exciter system and subsequently due to the unique balance of impact force and centrifugal force model AVH 6030 and model AVH 100-20 offer an excellent forward and reverse travel as well as astonishing climb ability in cohesive material. Vibration plates fitted with the triple shaft exciter system provide homogenous compaction without disturbing the top layer of the compacted soil due to a continuous contact to soil.

Powerful arguments:

- Fully hydraulic, infinite servo-control gives the highest precision for forward and reverse travel as well as for point compaction.
- Low-vibration control arm and operating system provides a maximum in maneuverability, an effortless working even over a long period of time and a fatigue-free operator.
- A compact working height of only 765 mm allows an additional layer of compaction below diagonal trench reinforcement.
- Engine and hydraulic components are completely covered to prevent damage during transportation and by fall-in debris during trench work.
- Universal application through optimal, variable co-ordination of frequency, centrifugal force and amplitude.
- Convenience is not an option standard feature include electric start for operator convenience in confined areas as well as for reliable starting during operation in cold temperatures. Folding central lifting point for quick and safe loading and unloading. Emergency-stop function at the end of the control arm (AVH 6030 optional).

Unique solution

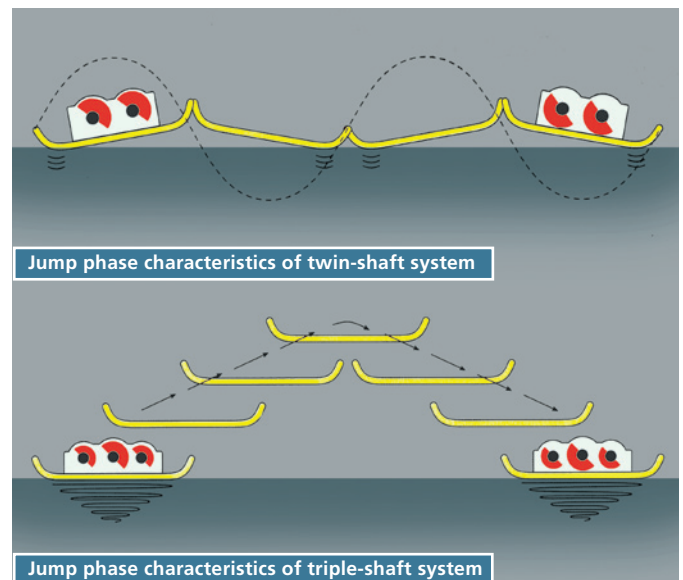



This is what the industry is getting excited about

The AVH 5030, AVH 6030 and AVH100-20 with unique triple-shaft exciter

Electric start and an electronic engine monitor are standard features on model AVH 100-20, the electric starter is optional on models AVH 5030 and AVH 6030:

- Robust and low maintenance battery with enhanced asset-reservoir and integrated carrying handles. The battery is bedded into a newly developed, vibration resistant, suspension system (AVH 100-20 only).
- An electronic shut off system protects the engine via solenoid, in case the engine's oil level reaches minimum
- Engine can not be restarted unintentionally when running
- All electric functions are cut off after two minutes, when the engine has been switched off via throttle and without turning the ignition off (model AVH 100-20 only)
- In case of low battery power, when it becomes necessary to start the engine manually with the provided crank, the electronic recognizes the manualstart and allows battery to re-load, provided the ignition switch is set in the "On" position (model AVH 100-20 only)

AVH 100-20 with Farymann diesel engine

In addition to the Hatz Supra diesel engine, the model AVH 100-20 now alternatively is available with the horizontally placed Farymann diesel engine 43 F. This guarantees a considerable low working height - which is an important feature regarding the operation in trenches protected by shuttering systems.

The oversized cyclone air filter, which is placed dust protected in the top section of the upper frame, ensures a trouble-free and longlasting operation in critical and dusty areas.



Precision servo operating convenience and Emergency Stop switch as standard (AVH 6030: optional equipment)



Fully hydraulic drive with powerful, Hatz diesel engine



Folding, single lifting point



Reliable, vibration resistant and service friendly battery



· Electric start
· Oil alert system
· no unintentional engine re-start
automatic engine cut-off in case of longer engine switch-off (without ignition turn-off) prevents discharge of battery (model AVH 100-20 only)



Effortless manual start with safety crank

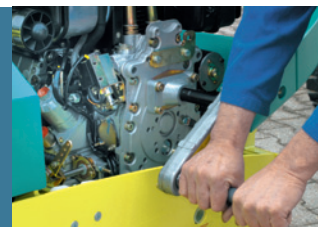



Universal application with the highest level of safety

Dead Man's Handle as an Option

Under certain circumstances – for example on confined sites – additional safety is needed when using heavy-duty vibrating plates.

The solution:

Special handles with electronic sensors in the guide handle register the touch of the operator and activate the hydraulics and exciter system, so that the machine is ready to use, provided the electric emergency button has been pulled out.

The electric emergency button and the control electronics of the dead man's handle are connected in series so that the hydraulics are immediately deactivated and the machine stops after a few centimetres when the emergency button is pressed or the handles are released, the engine remains in idle drive.

These are the corresponding advantages:

- The handles are highly sensitive – already the lightest touch of a finger suffices – the use of work gloves also does not pose a problem.
- No levers etc. need to be operated.
- Manipulation is virtually impossible: wrapping with wire etc. has no effect.
- The work of the operator is not restricted and tiresome restarting of the engine is also unnecessary.
- Sensor handles have already proven their efficiency in the area of agriculture.



Dead man's handle with electronic sensors (option)

Relative compaction control "ACEeco"

As an alternative to the ACE-system Ammann offers with the system „ACE eco“ the corresponding relative compaction control display. Hereby the operator is continuously informed about the achieved degree of compaction and the maximal feasible compaction.

“ACE eco” is available as option on models AVH 5030, 6030 and 100-20 (with electric starter only).



Compaction control system "ACEeco" (option)

Fully hydraulic and much more

Benefits and advantages at a glance

Functional design: the compact and foldable engine cover offers optimal protection of components and easy accessibility for service

A hydraulic pump to power drive and drive control eliminates an expensive and high-wearing v-belt system

Air-cooled Hatz or Faryman Diesel engine with integrated oil alert system powerful, service friendly and low emissions values

Emergency stop switch: vibration can be activated independently from engine drive

Control handle bar: ergonomically adjustable and lockable, with Orbitrol providing drive control

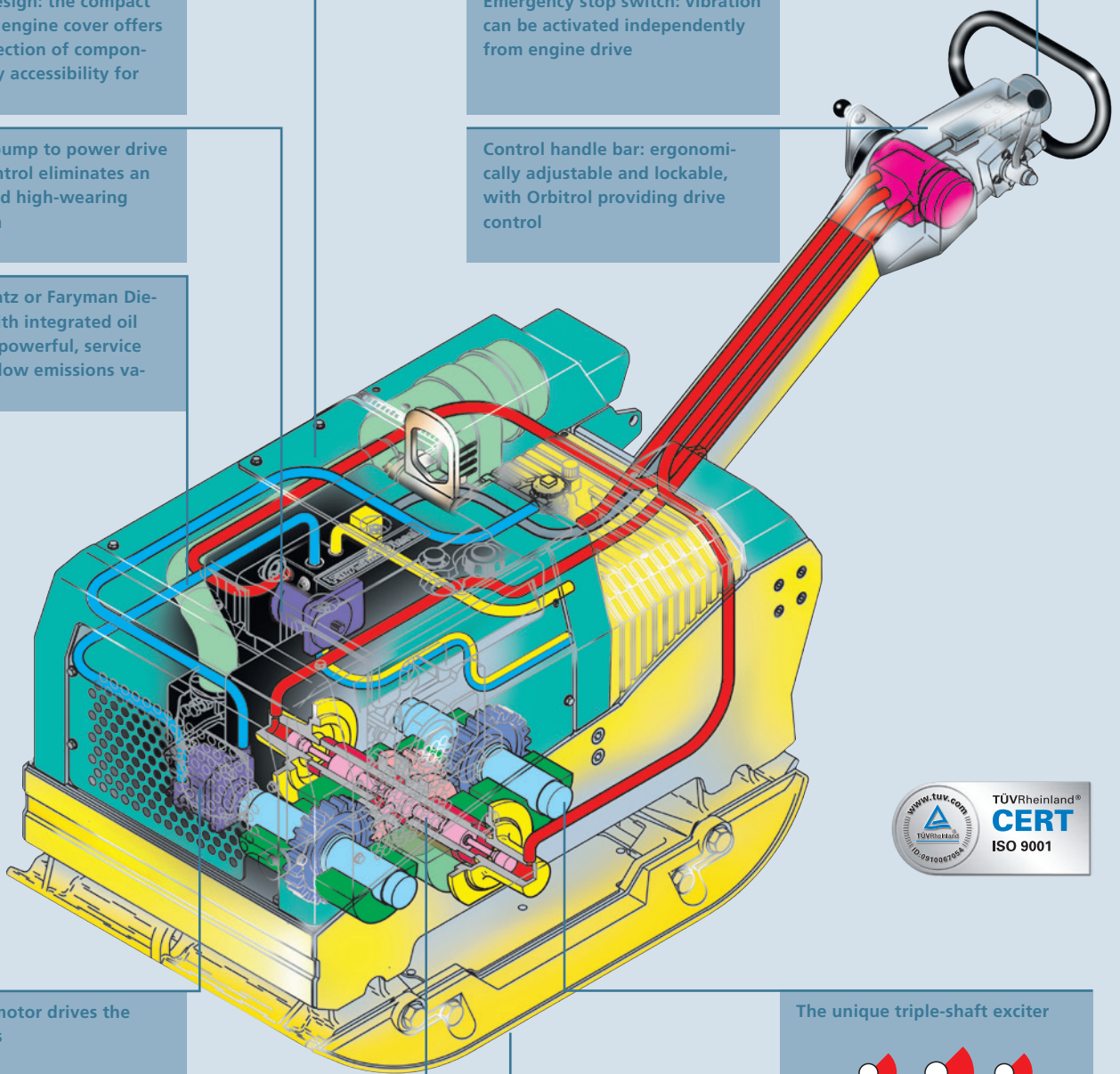

Hydrostatic motor drives the exciter shafts

Hydrostatic adjustment of the exciter shafts controlled by the Orbitrol on the handle bar

The unique triple-shaft exciter



Optimized shape of abrasion-resistant, self-cleaning cast iron base plate ensures balanced running performance, powerful drive and high climbability





Technical Data

		AVH 5030	AVH 6030	AVH 100-20	AVH 100-20
		Hatz Diesel	Hatz Diesel	Farymann Diesel	Hatz Diesel
Weight / Measurements					
Operating weight CECE basic unit	kg	401	480	680	680
with extension plates	kg	420/433	500/525	714/732	705/730
with e-start	kg	+ 30	+ 30		
Working width					
basic unit	mm	450	550	650	650
with extension plates	mm	600/750	700/850	800/950	800/950
Drive					
Engine type		Hatz 1 D 50S	Hatz 1 D 81S	Farymann 43F	Hatz 1 D 90S
Type		1 cyl./4-stroke-Diesel	1 cyl./4-stroke-Diesel	1 cyl./4-stroke-Diesel	1 cyl./4-stroke-Diesel
Power	HP/kW	9,4/7	13,5/10	15,0/11,0	14,8/10,9
at speed	U/min	2700	3000	3000	2900
Cooling		air	air	air	air
Fuel consumption	l/h	ca. 1,7	ca. 2,5	ca. 2,5	ca. 2,5
Tank capacity	l	5	7	7,5	10
Max. gradient	°	30	30	30	30
Max. climbability	%	36	36	36	36
Drive		hydraulic	hydraulic	hydraulic	hydraulic
Shift forward / reverse		hydraulic	hydraulic	hydraulic	hydraulic
Operating speed					
Variable	m/min	0-28	0-32	0-28	0-28
Vibration					
Centrifugal force	kN	50	60	100	100
Frequency	Hz	65	55	40	40
Maximum performance	m ² /h	594/792/990	925/1260/1430	1090/1350/1600	1090/1350/1600
Electric start		optional	optional	standard	standard
Max. compaction performance*					
sand/gravel	cm	70	90	100	100
cohesive soil	cm	30	30	40	40
Optional equipment					
extension plates	mm	75/150	75/150	75/150	75/150
operating hour meter		x	x	x	x
control system "ACEco"		x	x	x	x
emergency stop		x	x	standard	standard
dead man's handle		x	x	x	x

*depending on ground conditions

Specifications are subject to change due to technical improvements.

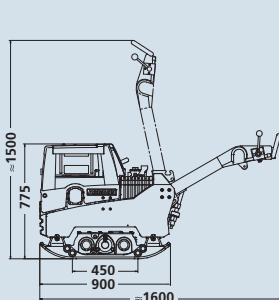

AVH 5030

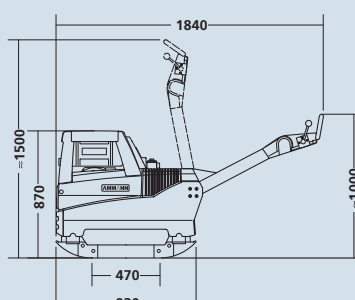

AVH 6030

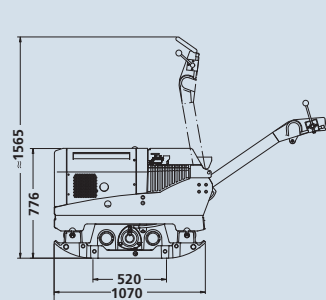

AVH 100-20 Farymann

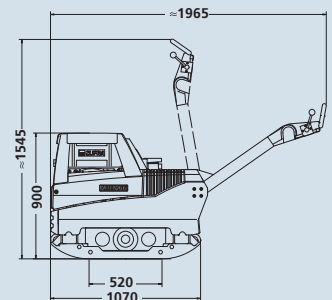

AVH 100-20 Hatz

Ammann distribution companies:

Germany:

Ammann Verdichtung GmbH
D-53773 Hennef
Tel +49 22 42 880 20
Fax +49 22 42 88 02 59
info.avd@ammann-group.com

France:

Ammann France SA
F-94046 Créteil/Cedex
Tel +33 1 45 17 08 88
Fax +33 1 45 17 08 90
info.afr@ammann-group.com

United Kingdom:

Ammann Equipment Ltd.
Bearley Stratford-upon-Avon
GB-Warwickshire, CV37 OTY
Tel +44 1789 414 525
Fax +44 1789 414 495
info.ael@ammann-group.com

USA:

Ammann America Inc.
Ponte Vedra, Florida 32082, USA
Tel +1 904 543 1691
Fax +1 904 543 1781
info@ammann-america.com

Poland:

Ammann Polska sp.zo.o.
02-230 Warszawa
Tel +48 22 33 77 900
Fax +48 22 33 77 929
info.aep@ammann-group.com

Russla:

Ammann Russland o.o.o.
RU-129343 Moskau
Tel +7 495 933 35 61
Fax +7 495 933 35 67
info.aru@ammann-group.com

Ammann manufacturing companies:

Switzerland:

Ammann Schweiz AG
CH-4901 Langenthal
Tel +41 62 916 63 56
Fax +41 62 916 64 03
info.aag@ammann-group.com

Germany:

Ammann Verdichtung GmbH
D-53773 Hennef
Tel +49 22 42 880 20
Fax +49 22 42 88 02 59
info.avd@ammann-group.com

Czech Republic:

Ammann Czech Republic a.s.
CZ-54901 Nové Město nad Metují
Tel +420 491 476 111
Fax +420 491 470 405
info.acz@ammann-group.com

